

Switching Lenses for RG MULTI EYEGUARDS

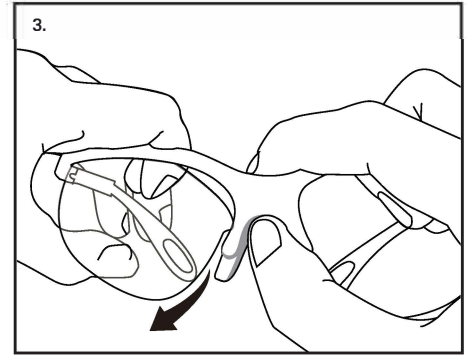
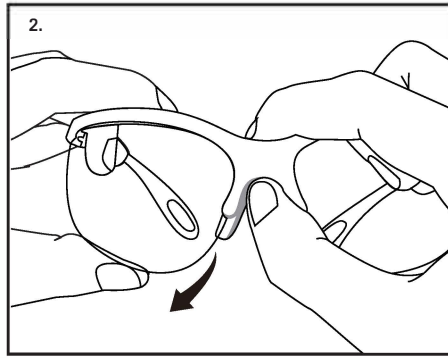
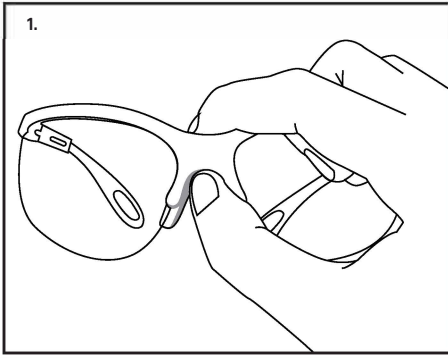

To remove Lens:

Remove the lens by supporting the frame at the nosepiece of the frame with your thumb or finger.

Support opposite side of the frame with other hand. Flex the frame slightly (frame is durable).

While the frame is flexed, pull the lens down and out to separate the lens from the frame.

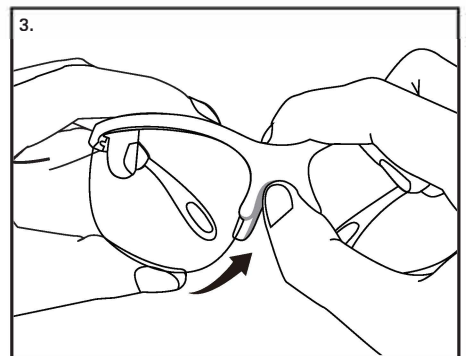
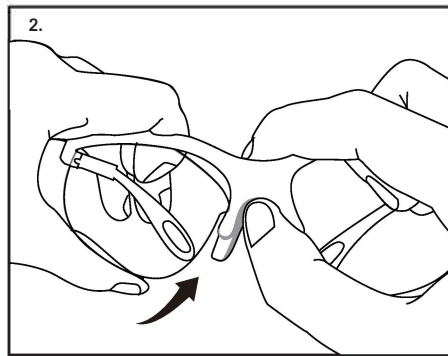
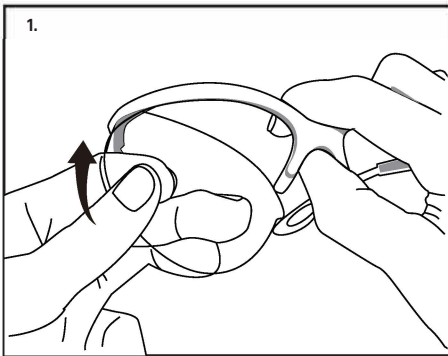

To install Lens:

Insert the tab of the lens into the groove at the corner of the frame by the hinge.

Support the frame and other lens with one hand, flex the frame slightly and then click the lens into the nosepiece area of the frame.

You will hear and feel a light click when the lens is secure within the frame.

Rython